

Coupling Detail

SL013014 is designed to couple System 25 to variety of adjacent window configurations, subject to structural capabilities. Therefore the fabricator must ensure that the window design can adequately accommodate the anticipated expansion and contraction. The coupling detail provides a tight butt joint. For further advice please contact Metal Technology's Technical Department.

Windows/doors to be screw fixed to coupling mullion at 600mm centres with additional door fixings 25mm above and below hinge positions. Coupling mullion to be lug fixed back to structure at head and cill using plates/straps (by fabricator) fixed to integral screwports within SL013014 profile. Metal Technology recommend that the SL013014 coupling mullion to be sealed and secured to the SL001002 outer frame, as indicated, prior to installation on site.

OUTER FRAME COUPLED WITH 4-20Hi+/5-20Hi+ OUTER FRAMES

Outer frame

100-200F ** 7275 screw length 'L' = 32mm

101-201F ** 7275 screw length 'L' = 32mm

102-202F ** 7287 screw length 'L' = 60mm

103-203F ** 7287 screw length 'L' = 60mm

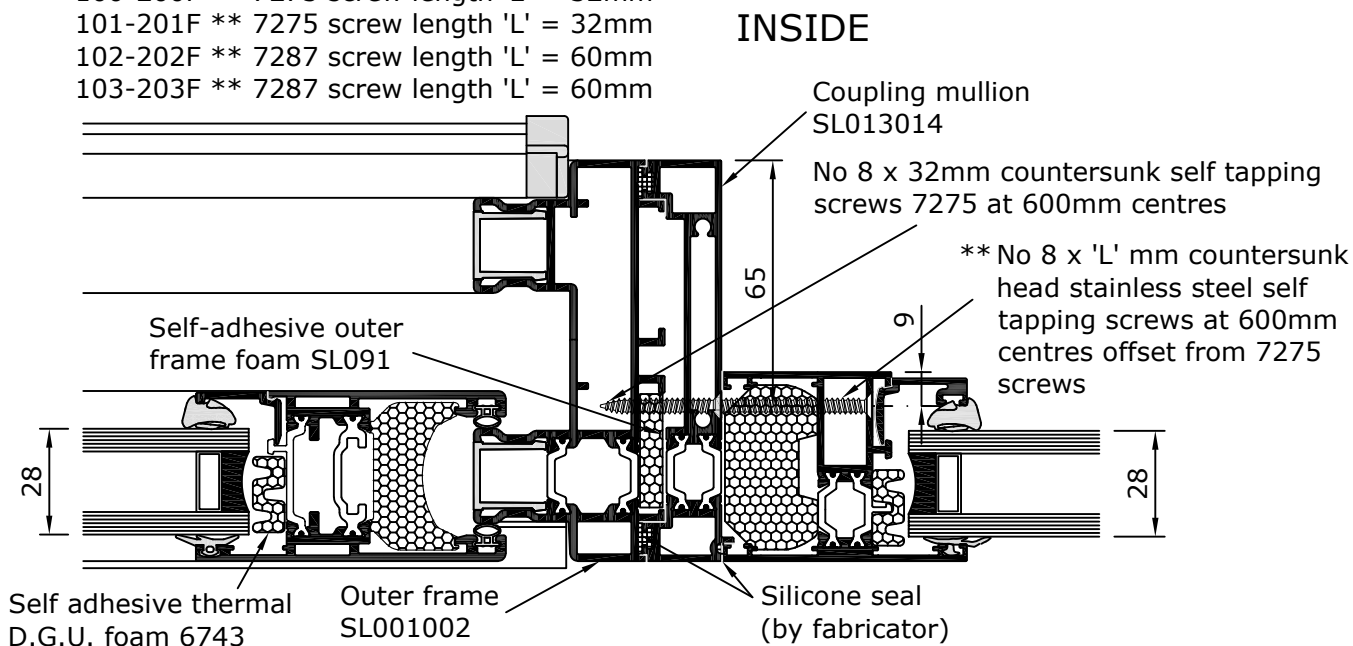

OUTER FRAME COUPLED WITH 4-35Hi+/5-35Hi+ OUTER FRAMES

Outer frame

600-200 ** 7275 screw length 'L' = 32mm

601-201 ** 7275 screw length 'L' = 32mm

602-202 ** 7287 screw length 'L' = 60mm

602-212 ** 7287 screw length 'L' = 60mm

604-213 ** 7276 screw length 'L' = 45mm

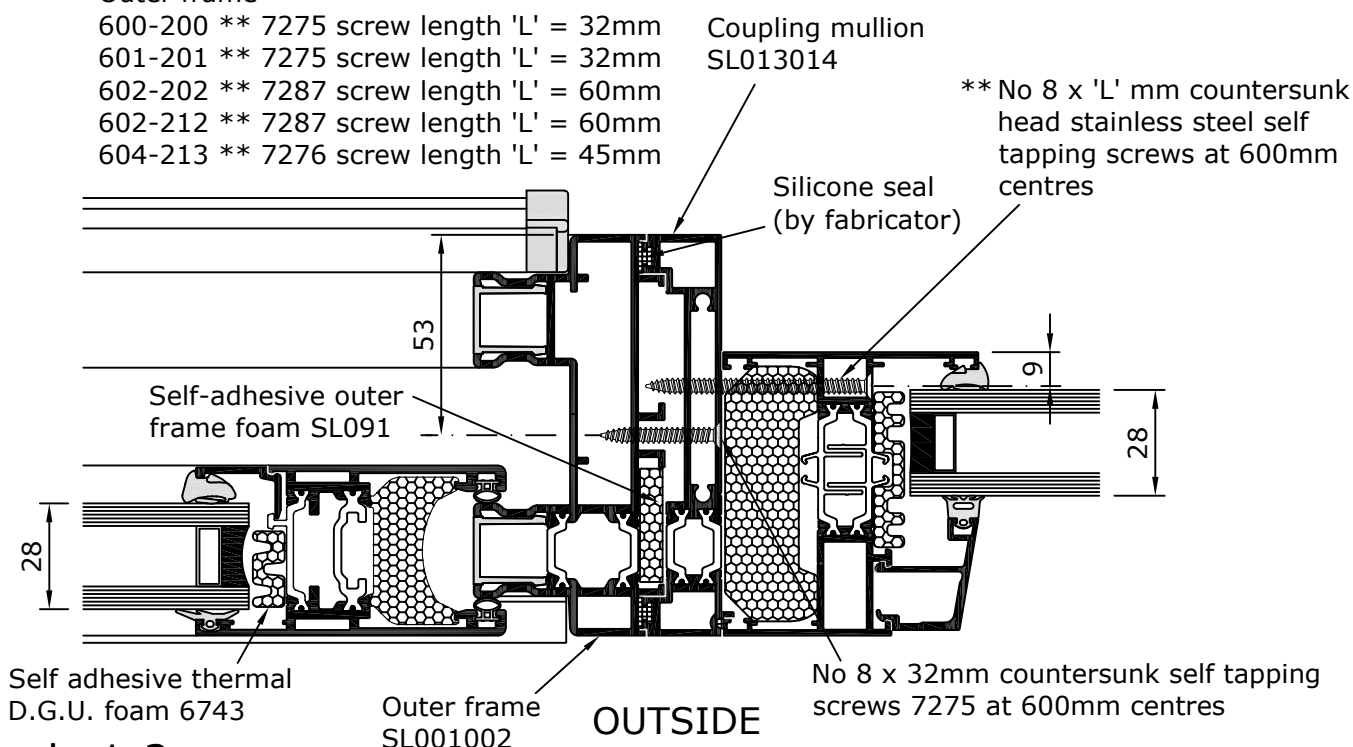

Scale 1:2